

SHEAR BUCKET

Range

PARTS MANUAL

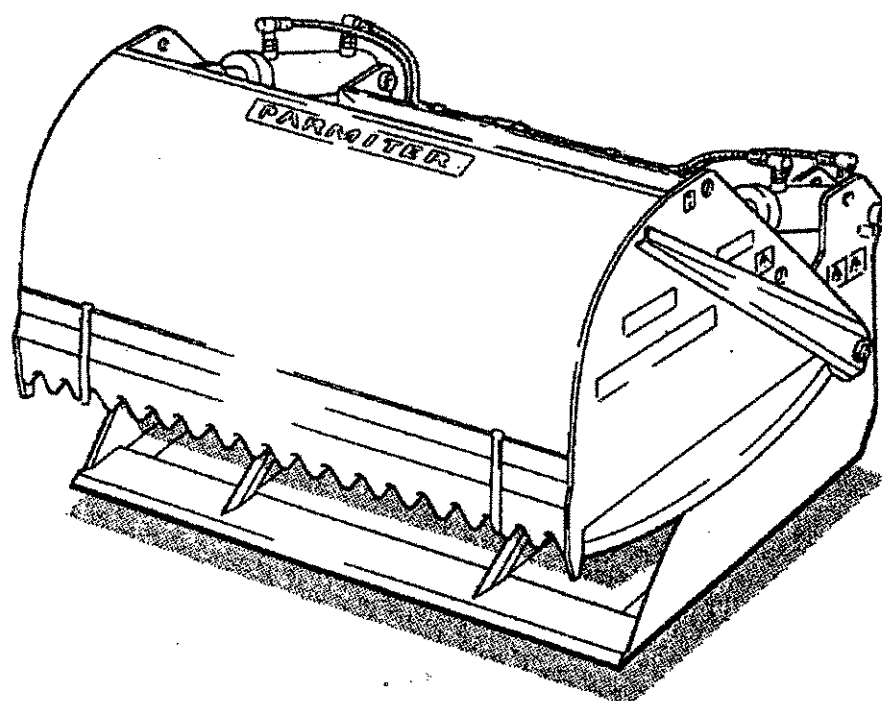

Shelbourne Reynolds Engineering Ltd
Stanton
Bury St Edmunds
Suffolk IP31 2AR
England
Telephone: (01359) 250415
Fax: (01359) 250464
Stores Tel: (01359) 251231
Stores Fax: (01359) 252031

ISSUE...2 18.04.2003

visit our website www.shelbourne.com

EC DECLARATION OF CONFORMITY

**We, Shelbourne Reynolds Engineering Ltd.
Of : Stanton, Bury St Edmunds
Suffolk, IP31 2AR, England.**

Hereby declare that the product :

SHEAR BUCKET

Parmiter Produced

MODEL	SERIAL NUMBER SERIES
SB150	BS15 2001 - BS15 3000
SB200	BS20 0500 - BS20 3000
SB250	BS25 3500 - BS25 5000
SB300	BS30 5500 - BS30 7000

Shelbourne Produced

Make Model Serial no

Conforms to the Essential Health & Safety Requirements of **EEC Directive 89/392/EEC**, as amended by **91/368/EEC,93/44/EEC**, and **93/68/EEC**.

To effect the correct application of the safety requirements stated in the EEC Directives, the following standards and / or technical specification has been used :

BS EN 292-1 : 1991 Safety of machinery - Basic concepts, general principals for design - Basic terminology, methodology.

BS EN 292-2 : 1991 Safety of machinery - Basic concepts, general principals for design - Technical principals and specifications.

BS EN 294 : 1992 Safety of Machinery - Safety distances to prevent danger zones being reached by the upper limbs.

BS 5401 : 1990 Guide to information content and presentation of operators manuals provided for tractors and machinery for agriculture and forestry.

Date of issue :

Place of issue :

Name and Job Function of Authorised Person :

Keith Shelbourne
Chairman
Managing Director



Signature _____

Dear Customer.

Thank you for purchasing a Shelbourne Parmiter Shear Bucket.

Shelbourne Parmiter have produced this Product Manual in line with the relevant essential Health and Safety regulations to help you achieve the very best from your machine, without harm to yourself. You should be aware that any other person operating your machine with your permission must be given adequate guidance and information to allow him, or her, to use the machine safely.

Where as every effort has been made to ensure that the Shear Bucket conforms to shelbourne Parmiters policy of quality, the machine cannot be expected to withstand abuse caused by misuse and negligence by the operator.

INTRODUCTION

The Shear Bucket is designed to both cut and hold blocks of Silage or other forms of animal feed, and then used to unload into suitable feeding arrangements. The bottom base has wear strips on it which help protect the blade and act as scrapers to ensure a clean floor at the dump area.

CONTENTS

Page	3	Product specification
Page	3	Safety rules and warning label identification
Page	4	Identification of the machine
Page	4	Handling of the Shear Bucket
Page	4	Preparation for work of the Shear Bucket
Page	6	Safe use of the Shear Bucket
Page	6	Adjustment of the Shear Bucket
Page	6	Maintenance of the Shear Bucket
Page	8	Possible dangerous misuses of the Shear Bucket
Page	9	Spare Part Illustrations and Identification
Page	13	Shelbourne Parmiter Warranty and Policy Notes

SPECIFICATION

MODEL	CAPACITY	DIMENSIONS	UNLADEN WEIGHT
SB/C200	0.922m ³ (32.55 ³ ft) 567kg (1250 lbs)	1.352m Wide 0.850m High 0.803m Deep	575 kg (1269 lbs)
SB/C250	1.128m ³ (39.82 ³ ft) 694kg (1530 lbs)	1.684m Wide 0.850m High 0.788m Deep	840 kg (1852 lbs)
SB/C300	1.341m ³ (47.35 ³ ft) 825kg (1819 lbs)	2.003m Wide 0.850m High 0.788m Deep	1095 kg (2414 lbs)

SAFETY RULES AND PICTOGRAM/LABEL IDENTIFICATION

Whenever possible, warning pictograms (labels with no words), or warning labels are used both on the machine near the area of danger and in the product manual near the relevant instructions.



Pictogram to indicate "Sharp Blade".



Pictogram to show "Alert, Warning".



Pictogram to indicate "Lifting Hook Location".

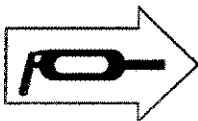

Pictogram to show "Lubrication Points".

1. Always comply with safety rules as set out in the pictograms, and detailed in this Product Manual.
2. Keep Shear Bucket closed at all times, except during maintenance of the blades, and when working.
3. The Shear Bucket must be used by the operator only, who will remain in the Prime Mover Vehicle (Tractor, or Material Handler) during the complete working cycle.

4. No bystanders must be allowed in the working area.
5. Whatever the type of maintenance that needs to be done on the Shear Bucket, the Prime Mover Vehicle's engine must be stopped.

IDENTIFICATION OF THE MACHINE

The Shear Bucket is identified by a makers plate located on the top box section of the cutting frame.

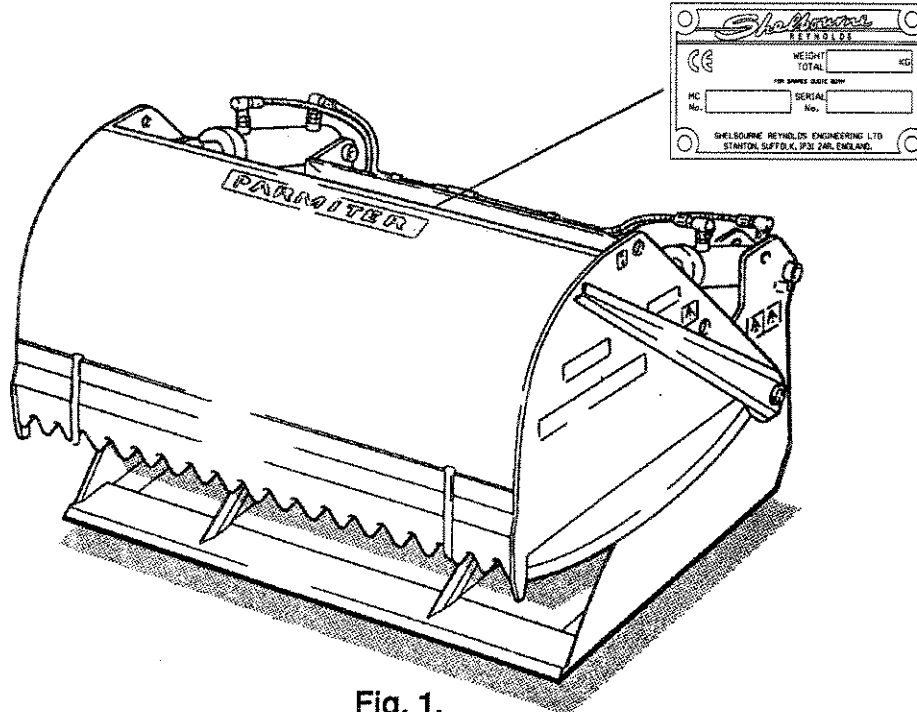
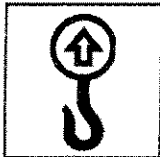

Fig. 1.

HANDLING OF THE SHEAR BUCKET



If the Shear Bucket has to be moved, it is recommended that the locating holes on the support frame and on the cutting frame are used for locating lifting hooks

PREPARATION FOR WORK OF THE SHEAR BUCKET

1. Before fitting the Shear Bucket to the Prime Mover Vehicle, check that the combined weight of the Shear Bucket and the heaviest Silage load does not exceed the manufacturers recommended safe loading of the front axle, wheels and tyres.

IMPORTANT

If the Shear Bucket mounting brackets are to be welded to the Rear Frame of the Shear Bucket, it is absolutely vital that the welding is carried out by a Professional Welder. The material to be welded must be pretreated and the final welds checked carefully. (See Fig. 2.)

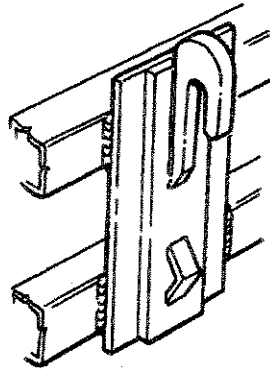

Fig. 2. Welded Bracket

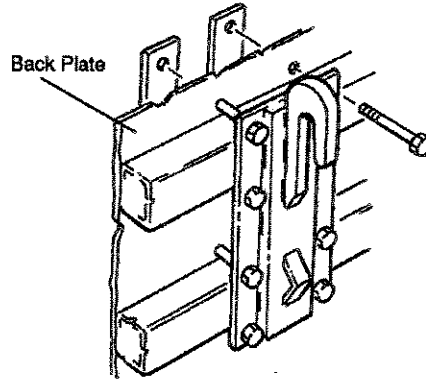

Fig. 2A. Bolted Bracket

2. If the Shear Bucket mounting brackets are to be bolted to the machine, it will be necessary to drill through the back plate to accept the mounting bolts and straps which are used to bolt the brackets to the rear frame. (See Fig. 2A)
3. The Shear Bucket requires a third double acting service on the Prime Mover Vehicle, operating at a minimum pressure of 136 Bar (2000 PSI), a maximum pressure of 205 bar (3000 PSI), and a minimum oil flow of 23 L/Min (5 Gal/Min).

Connect the hydraulic services to the Shear Bucket, using good quality double braid hoses, and slowly operate the hydraulic controls to ensure that the hydraulic pipes are correctly connected. Check visually, from a distance, that there are no oil leaks.

4. Open the Shear Bucket to the maximum opening, and fit the safety locking pin, Ref. A, Fig. 3. This will prevent the cutting frame from dropping when the Bucket is being worked upon.



Remove the guards and carefully, wearing heavy duty gloves, sharpen ALL of the cutting blades. Even though the machine is new, the blades lose their sharpness during their time through the factory and transportation. See maintenance chapter for full sharpening details.

Remove the safety locking pin and replace back into stowage hole, and reclip. Fig. 3 Ref B.

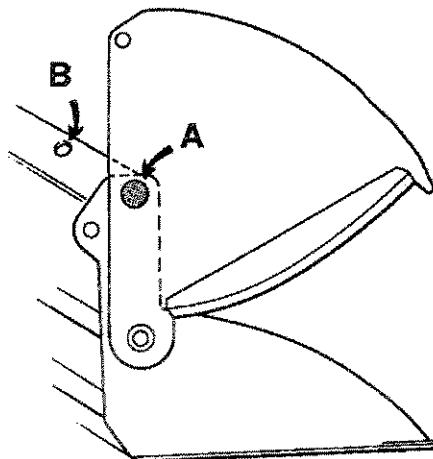

Fig. 3

5. When driving with the Shear Bucket, always keep the Bucket closed, and as low as possible.
6. Check again for loose fittings, snagged, or chafing hydraulic hoses.

The machine is now ready for use.

SAFE USE OF THE SHEAR BUCKET

1. Fully open the Shear Bucket, and raise it to the height where the Serrated teeth tips are just above, and clear of the block to be cut.
2. Level the Shear Bucket, and drive squarely into the Silage Clamp.
3. With the Shear Bucket front panel fully against the silage face, close the cutting frame.
4. Roll the Bucket back a few degrees to clear the remaining silage, then lift and reverse the machine out, clear off the silage face.



CAUTION

Note that it is vital that the Cutting Frame is fully closed before pulling back from the Silage face.

5. It is recommended that you start at one side of the clamp and work across the face. In this way a clean wall will be created with minimum wastage.
6. When finished, close the Bucket before parking, and carefully put the loose hydraulic hoses into the bucket, away from the ground.

ADJUSTMENTS OF THE SHEAR BUCKET

There are no adjustments to be made to the Shear Bucket

MAINTENANCE OF THE SHEAR BUCKET

DAILY

1. Check blades for sharpness and damage. Although the blades are of high quality Blade steel, they must have regular attention or the performance of the machine will suffer.



Before work is done on the blades, first fully open the cutting frame and secure open with the safety locking pin. Put on a pair of heavy duty gloves.

Normally, only a few moments of filing will maintain the edge, but if the edge has serious nicks or burrs, then a heavy duty file must be used to repair the damage. (See Fig. 4.)

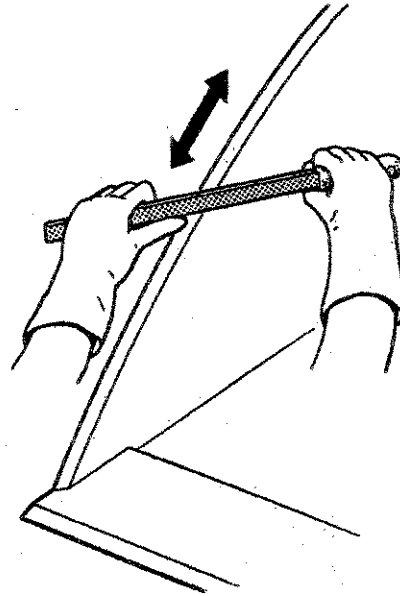

Fig. 4

IMPORTANT

Note that a rotary grinder must not be used as it would generate excessive heat and destroy the temper of the steel.

2. Check hydraulic hoses and fittings for signs of wear and chafing.

WEEKLY

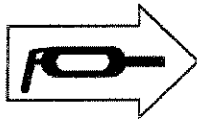

1. Grease all pivots, locations illustrated by Pictograms on machine
2. Check bottom plates for wear. (See Fig. 6.)

LONG TERM STORAGE

- a. Clean the machine thoroughly and paint over any bare surfaces
- b. Grease hydraulic ram rods
- c. Grease all cutting blades
- d. Completely close the Shear Bucket to protect the blades.

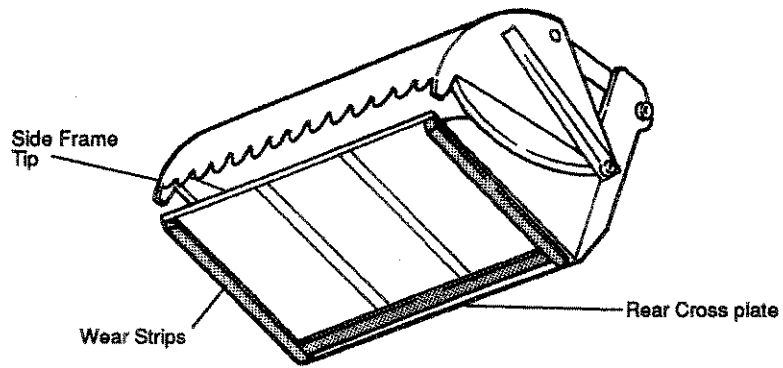

Fig. 5

POSSIBLE DANGEROUS USES OF THE SHEAR BUCKET

1. The Shear Bucket must not be used to carry personnel, or animals.
2. The Shear Bucket is a very strong machine with high cutting power, but it must not be used as a mobile guillotine around the farm.
3. It must be clearly understood that this machine is designed to cut and carry animal feed. If it is used as a standard bucket to carry materials such as metals, timber, rocks or aggregates, the blades will be irreparably damaged and the machine will fail to function.

Damage in this manner will invalidate the warranty.

SHEAR BUCKET ASSEMBLY

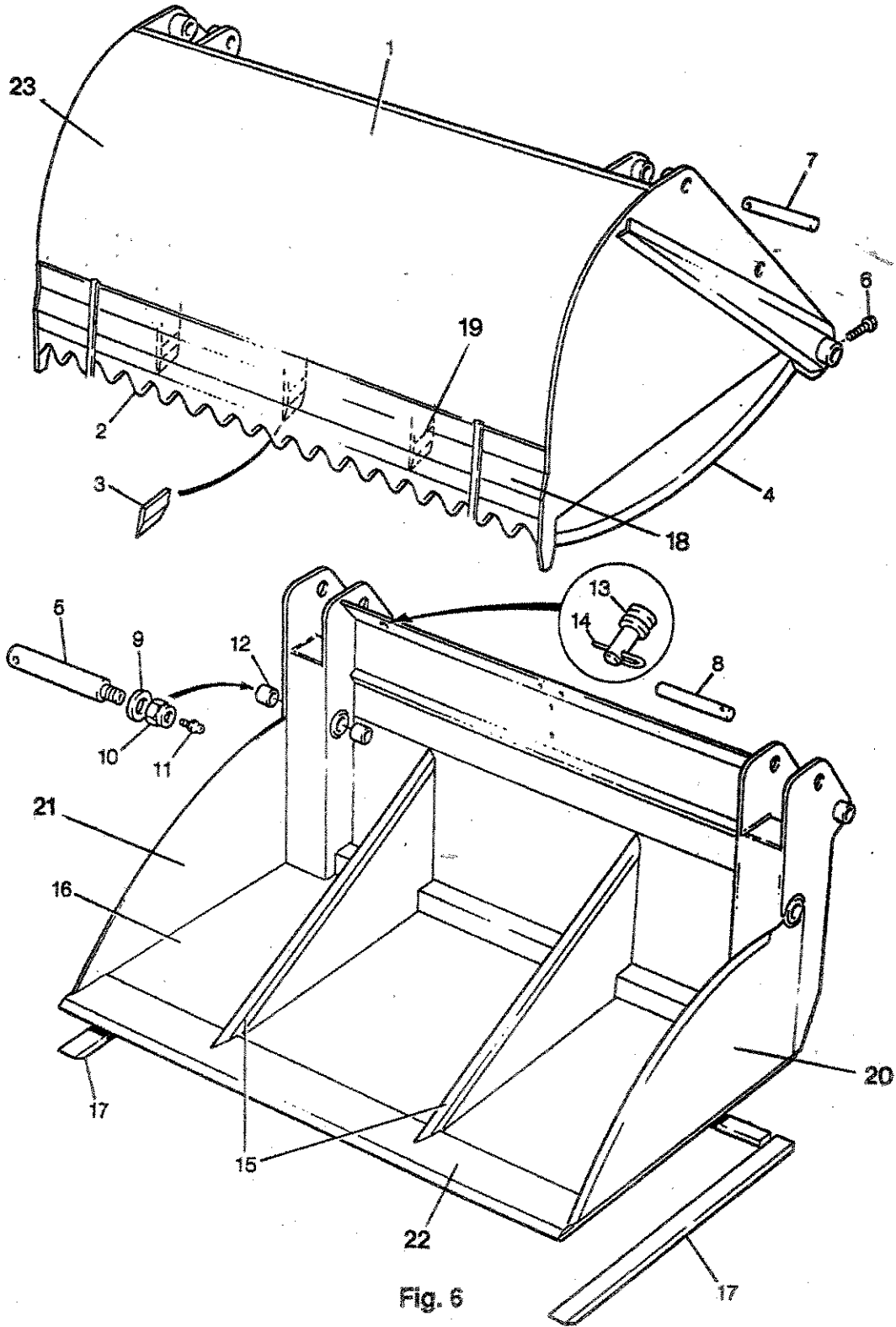

**SHEAR BUCKET ASSEMBLY
PARTS LIST**

Item No.	Part No.	Description	Quantity	
1	4309 0118	Cutting Frame W/A (SB 150)	1	
	4309 0089	Cutting Frame W/A (SB 200)	1	
	4309 0057	Cutting Frame W/A (SB 250)	1	
	4309 0075	Cutting Frame W/A (SB 300)	1	
2	4309 0218	Serrated Blade W/A (SB 150)	1	
	4310 0162	Serrated Blade W/A (SB 200)	1	
	4310 0163	Serrated Blade W/A (SB 250)	1	
	4310 0164	Serrated Blade W/A (SB 300)	1	
3	2160 2021	Centre Blade	A/R	
4	2160 2062	Side Blade	2	
	3309 0192	Side Blade (SB 150 & SB 200)	2	
5	3310 0322	Pivot Pin 40 dia. (SB 250 & SB 300)	2	
6	2014 6118	Hex Bolt, M12 x 90	2	
7	3310 0129	Headless Pin, 30 dia. (SB 150)	2	
	3310 0129	Headless Pin, 30 dia. (SB 200 & SB 250)	2	
	3309 0170	Headless Pin, 30 dia. (SB 300)	2	
8	3309 0174	Headless Pin, 30 dia. (SB 150)	2	
	3309 0174	Headless Pin, 30 dia. (SB 200)	2	
	3309 0128	Headless Pin, 30 dia. (SB 250 & SB 300)	2	
9	2070 7061	Washer	2	
10	2037 6700	Lock Nut	2	
11	2061 3001	Grease Nipple	2	
12	2117 4040	Bush	4	
13	3309 0062	Pin (Safety Locking)	1	
14	2172 8201	Pin 'D' Type	1	
15	2160 2050	Blade	A/R	
16	4309 0117	Support Frame W/A (SB 150)	1	
	4309 0088	Support Frame W/A (SB 200)	1	
	4309 0056	Support Frame W/A (SB 250)	1	
	4309 0076	Support Frame W/A (SB 300)	1	
17	4309 0217	Wear Plates (SB 150)	1	(KIT)
	4309 0100	Wear Plates (SB 200)	1	(KIT)
	4309 0101	Wear Plates (SB 250)	1	(KIT)
	4309 0102	Wear Plates (SB 300)	1	(KIT)
18	3309 0191	Blade Carrier (SB 150)	1	
	3310 0238	Blade Carrier (SB 200)	1	
	3309 0105	Blade Carrier (SB 250)	1	
	3309 0195	Blade Carrier (SB 300)	1	
19	3309 0140	Carrier Support	1	
20	2160 2066	LH Support frame blade	1	
21	2160 2067	RH Support frame blade	1	
22	2160 2092	Front Blade (SB 150 C)	1	
	2160 2065	Front Blade (SB 200 C)	1	
	2160 2063	Front Blade (SB 250 C)	1	
	2160 2064	Front Blade (SB 300 C)	1	
23	3309 0188	Maize Plate (SB 150)	1	
	3309 0168	Maize Plate (SB 200)	1	
	3309 0106	Maize Plate (SB 250)	1	
	3309 0119	Maize Plate (SB 300)	1	

SHEAR BUCKET - HYDRAULICS

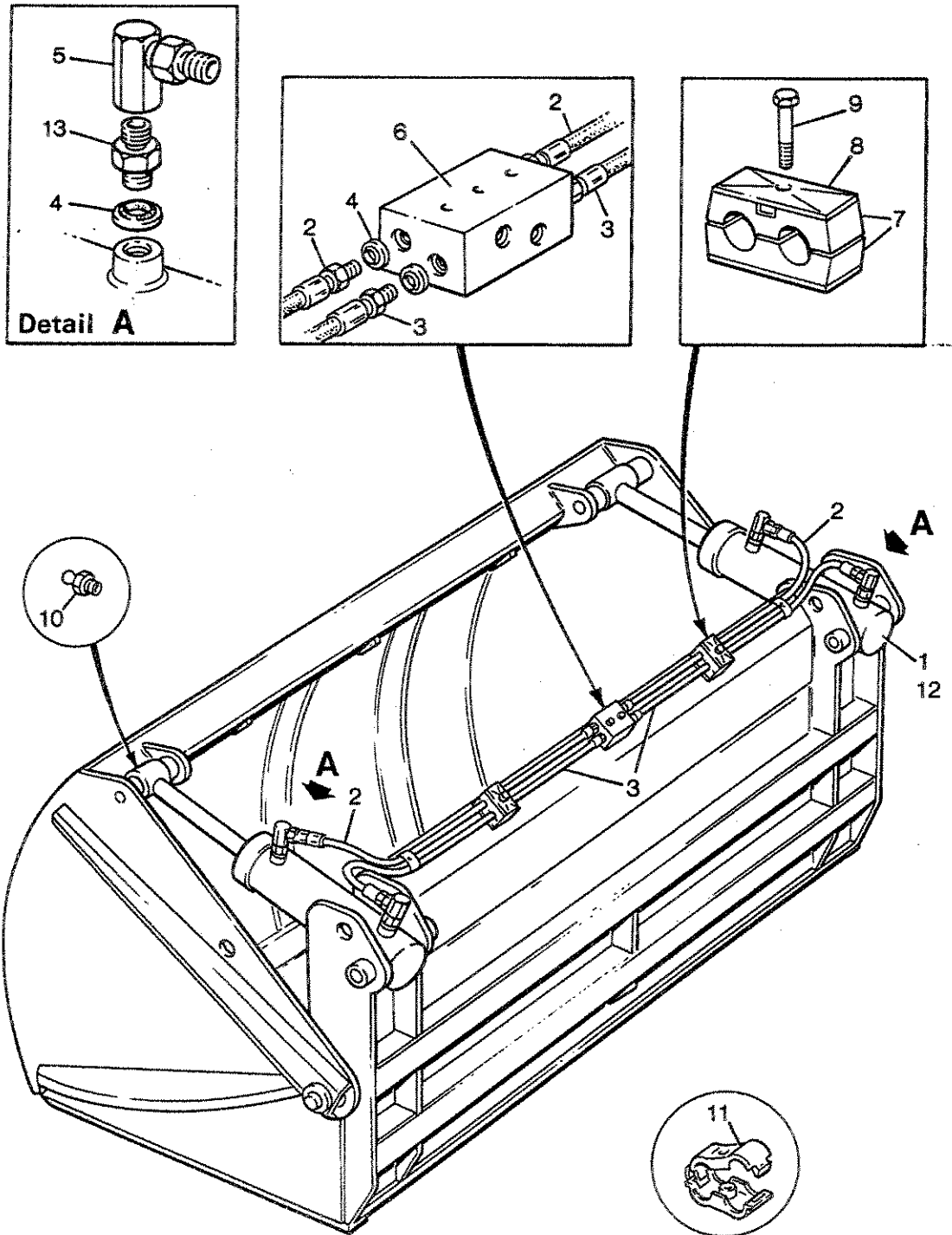

Fig. 7

SHEAR BUCKET - HYDRAULICS

PARTS LIST

Item No.	Part No.	Description	Quantity
1	2131 1038	Ram (SB 200)	2
	2131 1066	Ram (SB 250)	2
	2131 1086	Ram (SB 300)	2
2	2131 8609	Hose 1175 Long (SB 200)	2
	2131 8610	Hose 1325 Long (SB 250)	2
	2131 8606	Hose 1500 Long (SB 300)	2
3	2131 8608	Hose 850 Long (SB 200)	2
	2131 8602	Hose 1000 Long (SB 250)	2
	2131 8611	Hose 1125 Long (SB 300)	2
4	2130 7501	Sealing Washer, M18	8
5	2130 4068	Adaptor, M18 x 90°	4
6	2131 7037	Manifold	1
7	2131 3054	Clamp, paired	2
8	2131 3055	Cover Plate	2
9	2012 6109	Hex Bolt, M8 x 45	4
10	2061 3001	Grease Nipple, M10	2
11	2170 9067	Hose Clip	2
12	2131 2020	Seal Kit for Hydraulic Ram (SB 200)	2
	2131 2067	Seal Kit for Hydraulic Ram (SB 250)	2
	2131 2085	Seal Kit for Hydraulic Ram (SB 300)	2
13	2130 4060	Adaptor M18 x M18	4

SHELBOURNE PARMITER POLICY NOTE

Shelbourne Parmiter policy is one of continuous improvement. We reserve the right to change prices or specifications of equipment at any time without notice. Order are accepted subject to our standard conditions of sale. All weights and measures shown in this brochure are approximate.

WARRANTY

As part of Shelbourne Parmiter's After-sales back-up programme, we have a full, comprehensive Dealer Support Service

For details of our Warranty Policy, please see your own Shelbourne Parmiter Authorised Dealer.