



# OVERVIEW OF THE WIRING BUNDLE

**XEOS TF**

01.2016 < \_ \_

FRONT HOPPER

TRACTOR

DRILLING TOOLBAR

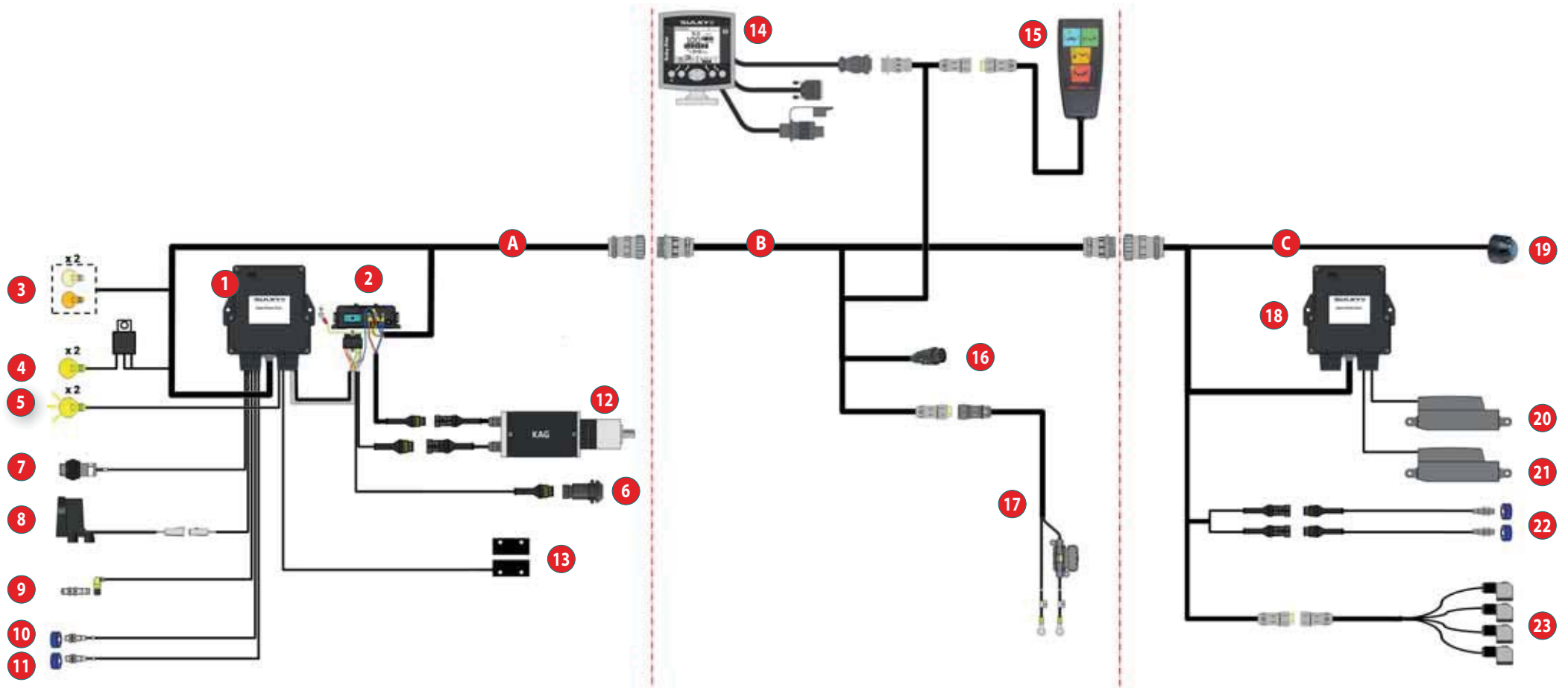



# OVERVIEW OF THE WIRING BUNDLE

## XEOS TF

MARK	DESCRIPTION	PART REF.
<b>A</b>	TF front wiring bundle	983675
<b>1</b>	Pilot connection box	983672
<b>2</b>	MCM module => Cable to ECU =>	983689 983993
<b>3</b>	Sidelight + Indicator	983942
<b>4</b>	Road lights => Road lights relay =>	983941 721981
<b>5</b>	LED Working lights	983940
<b>6</b>	Calibration test push-button	983988
<b>7</b>	Low seed level sensor	983917
<b>8</b>	Radar => Radar cable =>	983984 983765
<b>9</b>	Fan sensor => Fan sensor cable	721579 721654
<b>10</b>	Motor start-up ILS sensor	983912
<b>11</b>	Motor stop ILS sensor	983912
<b>12</b>	KAG electric motor Power cable =>	983967 721982
<b>13</b>	Flap sensor => Magnet =>	713000 713010

MARK	DESCRIPTION	PART REF.
<b>B</b>	TF tractor wiring bundle	983674
<b>14</b>	TF PILOT console	722006
<b>15</b>	Electro-hydraulic control Unisoc / Unidisc LSW	983386
	Electro-hydraulic control Cultidisc LSW	983387
<b>16</b>	Lighting plug	
<b>17</b>	40 A direct battery power supply	983741

MARK	DESCRIPTION	PART REF.
<b>C</b>	RF rear wiring bundle	983676
<b>18</b>	Pilot connection box	983672
<b>19</b>	Rear road lighting plug	
<b>20</b>	Tramline actuator	982507
<b>21</b>	Half seed drill actuator	982507
<b>22</b>	Drilling toolbar lift safety sensors	983722
<b>23</b>	Solenoid valve connector wiring bundle	983974
	Tramlining solenoid valve connector	983642



### FRONT SENSOR CONNECTION BOX



01.2016

